

- NOTES:**
- IMPACT RESISTANT GLAZING OPTION— IMPACT RESISTANT GLAZING SYSTEM MAY BE INSTALLED IN TOP OR INTERMEDIATE SECTION (WITH OR WITHOUT DECORATIVE INSERTS) GLAZING SHALL BE 1/4" POLYCARBONATE. MINIMUM GLAZING DIMENSIONS SHALL BE 1" x 1" CUTOUT FASTENED WITH #8 X 1" SMS 3X ALONG THE HORIZONTAL AND 2X ALONG THE VERTICAL. SEE DETAIL E ON SHEET 2 FOR ASSEMBLY DETAILS.
 - NON-IMPACT RESISTANT GLAZING OPTION— .090" MINIMUM SSB GLAZING IN MOLDED FRAMES SCREWED TOGETHER WITH A MINIMUM OF (10) #8X1 SCREWS INSTALLED IN TOP OR INTERMEDIATE SECTION (WITH OR WITHOUT DECORATIVE INSERTS) MEETS UNIFORM OR STATIC WIND PRESSURES SHOWN ON THIS DRAWING. GLAZING SHALL HAVE A MAXIMUM HEIGHT OF 10.69" AND A MAXIMUM LENGTH OF 16.94". GLAZING IS NOT IMPACT RESISTANT AND DOES NOT MEET THE REQUIREMENTS FOR WIND-BORNE DEBRIS REGIONS.
 - VINYL OR WOOD DOOR STOP NAILED A MAXIMUM OF 6 O.C. MUST OVERLAP TOP AND BOTH ENDS OF PANELS MINIMUM 7/16" TO MEET NEGATIVE PRESSURES.
 - KEY LOCK, SLIDE LOCKS, OR OPERATOR REQUIRED.
 - LOUVER OPTION — .040" MINIMUM LOUVERS IN MOLDED FRAMES SCREWED TOGETHER WITH A MINIMUM OF (10) #8X1 SCREWS INSTALLED IN THE BOTTOM SECTION. LOUVERS ARE NOT IMPACT RESISTANT AND DO NOT MEET THE REQUIREMENTS FOR WIND-BORNE DEBRIS REGIONS.
 - SECTION STEEL TO HAVE A MINIMUM 26 GA THICKNESS.
 - THE DESIGN OF THE SUPPORTING STRUCTURAL ELEMENTS SHALL BE THE RESPONSIBILITY OF THE PROFESSIONAL OF RECORD FOR THE BUILDING OR STRUCTURE AND IN ACCORDANCE WITH CURRENT BUILDING CODES FOR THE LOADS LISTED ON THIS DRAWING.
 - DOOR JAMB TO BE MINIMUM 2x4 STRUCTURAL GRADE LUMBER. REFER TO JAMB CONNECTION SUPPLEMENT FOR ATTACHMENT TO SUPPORTING STRUCTURE.
 - FOR LOW HEAD ROOM LIFT CONDITIONS, TOP BRACKET SHALL BE A 13 GA LHR 7/4 TOP BRACKET WITH A MINIMUM OF (3) 1/4-14x7/8" SELF DRILLING CRIMPTE SCREWS IN LIEU OF THE BRACKET SHOWN ON THIS DRAWING. U-BAR ON TOP SECTION SHALL BE INSTALLED ON TOP OF LHR TOP BRACKETS.

SUPERIMPOSED DESIGN PRESSURE LOADS ON SUPPORTING STRUCTURE

DOOR WIDTH	DOOR HEIGHT	UNIFORM LOAD EACH JAMB (PLF)
10'-0"	ALL	+172.0/-191.5
12'-0"	ALL	+206.7/-229.8
14'-0"	ALL	+240.6/-268.1
15'-0"	ALL	+258.0/-287.3
16'-0"	ALL	+273.2/-306.4

NOTE:
 (JB-US) FOLLOWING DIMENSION DENOTES SLOTTED JAMB BRACKET ATTACHED TO TRACK WITH 1/4-20x9/16" TRACK BOLT AND NUT AS SHOWN ABOVE.
 ALL DOORS GREATER THAN 8' IN HEIGHT REQUIRE USE OF CONTINUOUS WALL ANGLE. SEE SUPPLEMENT TRACK CHART FOR DETAILS.

MARK A SAWICKI, PE
 2501 S. STATE HWY 121, SUITE 200
 LEWISVILLE, TX 75067
 TX PE 72613
 TX PE 062931

PROFESSIONAL ENGINEER'S SEAL PROVIDED ONLY FOR VERIFICATION OF WINDLOAD CONSTRUCTION DETAILS.

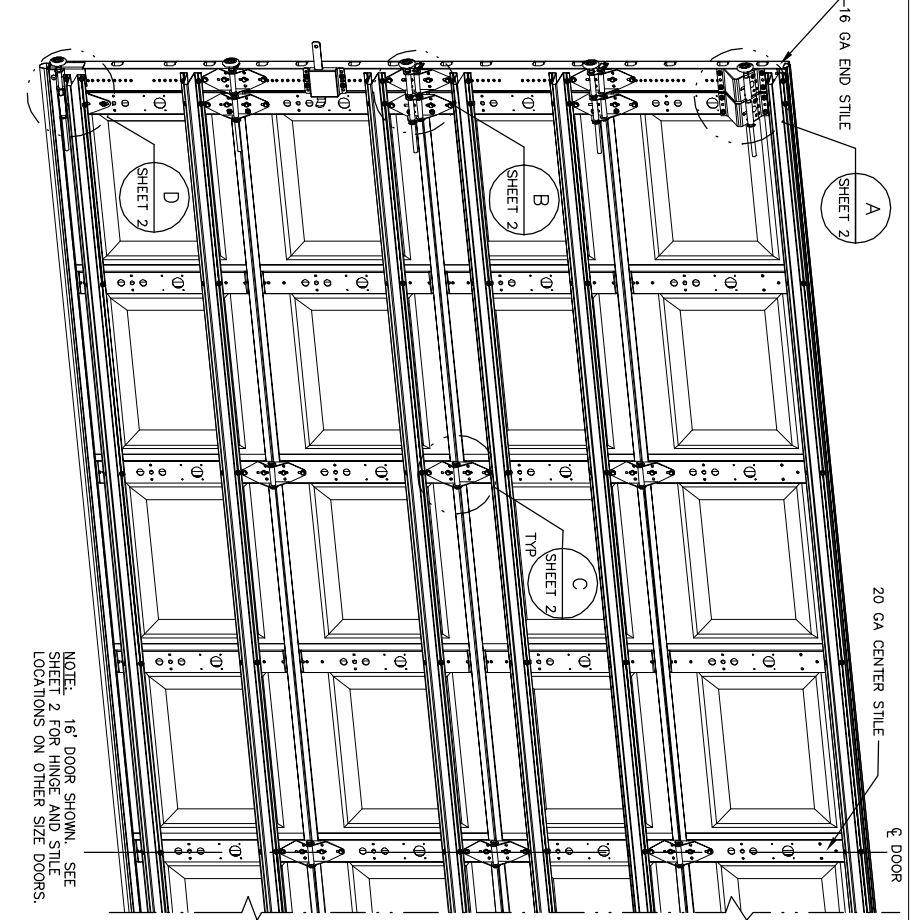
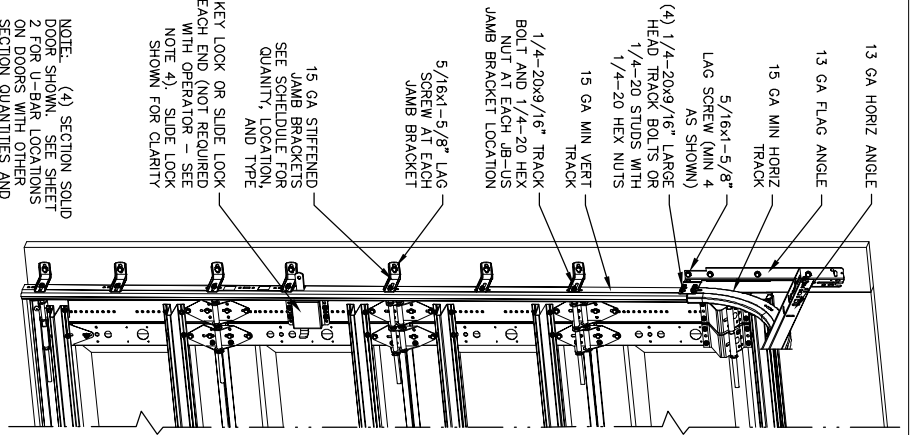

NOTE: (4) SECTION SOLID DOOR SHOWN. SEE SHEET 2 FOR U-BAR LOCATIONS ON DOORS WITH OTHER SECTION QUANTITIES AND SEE NOTES 1 AND 2 THIS SHEET FOR GLAZING OPTIONS.

NOTE: 16' DOOR SHOWN. SEE SHEET 2 FOR HINGE AND STILE LOCATIONS ON OTHER SIZE DOORS.

JAMB BRACKET SCHEDULE

LOCATION OF CENTERLINE OF JAMB BRACKETS MEASURED FROM BOTTOM OF TRACK (ALL DIMENSIONS ± 2")

DOOR HEIGHT (SECTIONS) (EACH JAMB)	NO. OF BRACKETS	NO. OF JAMB BRACKETS
6'-6"	4	7
7'-0"	4	7
7'-6"	5	9
8'-0"	5	9
8'-0"	5	9

SEE NOTE BELOW

- REVISIONS**
- MODIFIED NOTES TO STATE THAT LOUVERS ARE NOT IMPACT RESISTANT. GRT 6/29/07
 - ADDED IMPACT RESISTANT GLAZING. FORBIDDEN DETAIL E, SHEET 2 FOR GLAZING. SEE MAX GLAZING DIMENSION TO NOTES SHEET 1. MODIFIED JAMB BRACKET SCHEDULE. ADDED TRACK TO FLAG CONNECTION NOTE. GRT 11/10/07
 - MODIFIED LOUVER OPTION. ADDED TEXAS LICENSE NUMBER TO TITLE BLOCK. GRT 9/19/08
 - UPDATED TITLE BLOCK AND IMPACT GLAZING GRT 4/16/12

A DIVISION OF OVERHEAD DOOR CORP.
 3395 ADDISON DRIVE
 PENSACOLA, FLORIDA 32514
 (850) 474-9890

STATIC PRESSURE RATINGS	APPROVED SIZES	SCALE: N.T.S.	SIZE: A
DESIGN (PSF): +34.40/-38.30	MAX WIDTH: 16'-0"	DATE	NAME
TEST (PSF): +51.60/-57.45	MAX HEIGHT: 14'-0"	DRAWN	GRT
IMPACT/CYCLIC RATED (YES/NO): YES	MAX SECTION HEIGHT: 21"	CHECKED	MRB
MODELS 8000/8100		SHEET 1 OF 2	REV.
WINDLOAD SPECIFICATION OPTION CODE 1124		DRAWING PART NO.	P4

CENTRAL STILE & INTERMEDIATE HINGE LOCATIONS

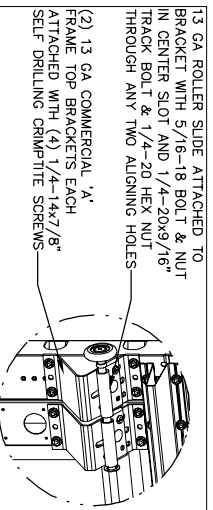

DETAIL A

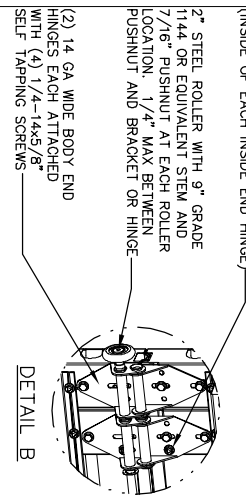

DETAIL B

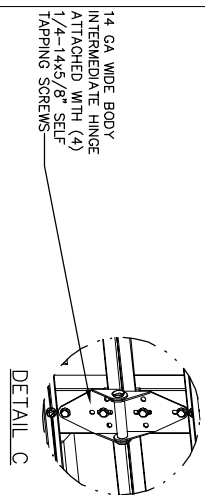

DETAIL C

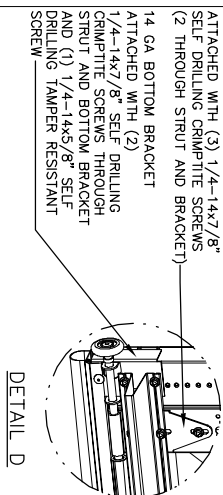

DETAIL D

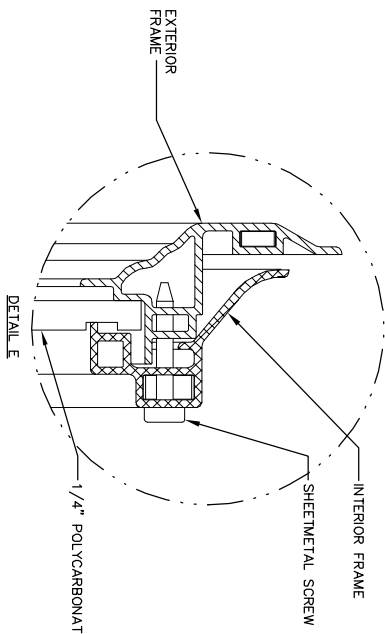
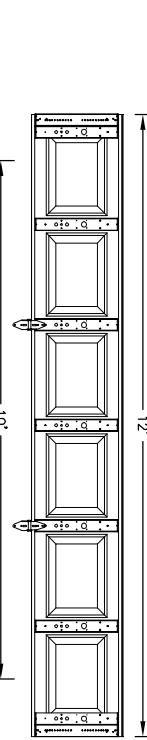
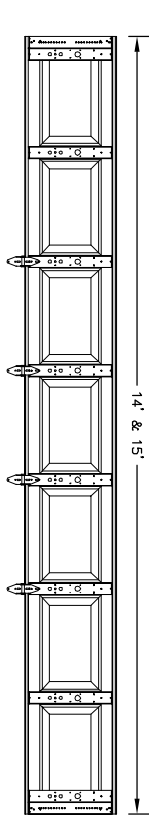
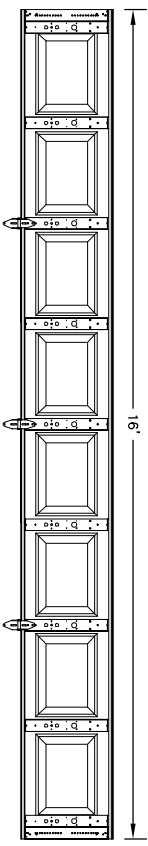

ATTACH U-BAR WITH (2) 1/4-14x7/8" SELF DRILLING CRIMP-TITE SCREWS AT EACH STILE LOCATION, TYP.

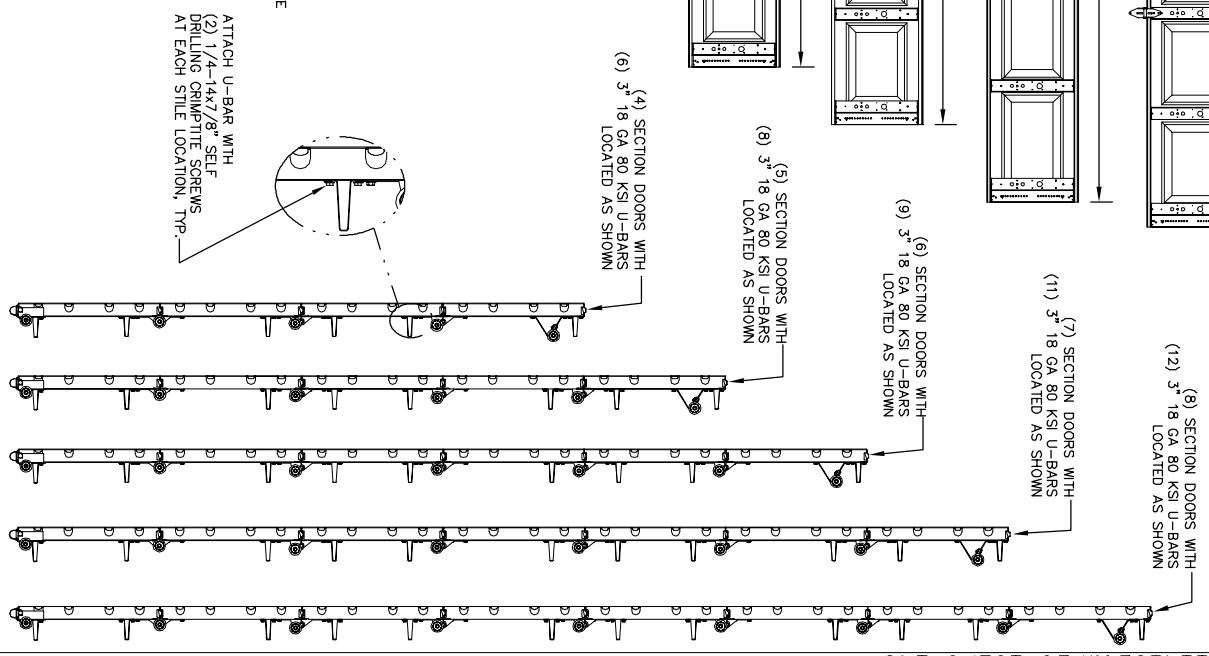

U-BAR LOCATIONS

REVISIONS

P1 MODIFIED NOTES TO STATE THAT LOUVERS ARE NOT IMPACT RESISTANT.
GRT 6/29/07

P2 ADDED IMPACT RESISTANT GLAZING. FODDED DETAIL E SHEET 2 FOR GLAZING. E-SEED MAX FOR GLAZING. EXTENSION TO NOTES SHEET 1. MODIFIED UAMB BRACKET. ADDED TRACK TO FLAG CONNECTION.
NOTE
GRT 11/10/07

P3 MODIFIED LOUVER OPTION. ADDED TEXAS LICENSE NUMBER TO TITLE BLOCK.
GRT 9/19/08

P4 UPDATED TITLE BLOCK AND IMPACT GLAZING
GRT 4/16/12

MARK A. SAWICKI, PE
2501 S. STATE HWY 121, SUITE 200
LEWISVILLE, TX 75087
TX PE 72813
TX PE 169291

PROFESSIONAL ENGINEER'S SEAL PROVIDED ONLY FOR VERIFICATION OF WINDLOAD CONSTRUCTION DETAILS.

A DIVISION OF OVERHEAD DOOR CORP.
3395 ADDISON DRIVE
PENSACOLA, FLORIDA 32514
(850) 474-9890

STATIC PRESSURE RATINGS		APPROVED SIZES		SCALE: N.T.S.	
DESIGN (PSF):	+34.40/-38.30	MAX WIDTH:	16'-0"	DATE	NAME
TEST (PSF):	+51.60/-57.45	MAX HEIGHT:	14'-0"	DRAWN	5/23/06
IMPACT/CYCLIC RATED (YES/NO):	YES	MAX SECTION HEIGHT:	21'	CHECKED	1/22/07
MODELS 8000/8100			SHEET 2 OF 2		
WINDLOAD SPECIFICATION OPTION CODE 1124			DRAWING PART NO. 327018		
			REV. P4		